

Objective

This manual is prepared for the benefit of terminal users, transporters, vessel master, shipping agents and vessel crew at wharf on evacuation plan during emergency.

Northport (Malaysia) Bhd

Jalan Pelabuhan, Pelabuhan Utara,
42000, Port Klang, Selangor,
Malaysia.
+603-31698888
www.northport.com.my

Map 1

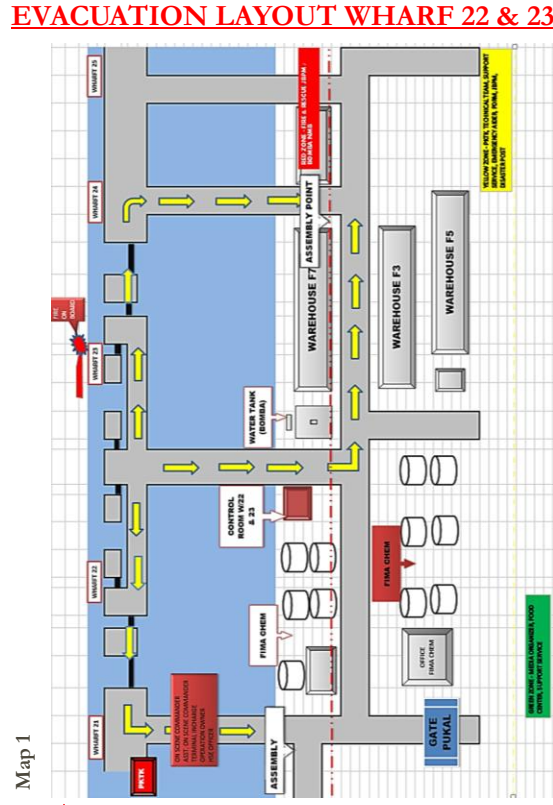

SAFETY GUIDELINE FOR LIQUID BULK TERMINAL

Liquid Bulk Terminal (LBT) operation generally follows the instructions and recommendations issued by the International Safety Guideline for Oil Tankers and Terminals (ISGOTT).



Emergency Response

	On Vessel	On Berth
Action by Vessel	Trigger the alarm	Report to LBT officer via phone hotline, or pilot office using VHF Channel 12
Action by Terminal	Loading master immediately cease cargo operations & inform LBT officer	Loading master immediately cease cargo operations & inform LBT officer
Evacuation	Evacuate from vessel via gangway	All shore personnel shall proceed to the assembly point outside the terminal

In case of fire, please trigger the alarm

Terminal Fire Alarm

- At the terminal, the fire alarm signal is continuously increasing (whistle or siren)

Ship Fire Alarm when alongside Wharf Terminal

- Sound one or more blasts on the ship horn, each blast of not less than ten seconds duration supplemented by a continuous sounding of the general alarm system

Key Personnel

Operation Executive on duty

- 019-2119309
- 03-31698832

Ast. Manager on duty :

Mr. Afiq Afandy Bin Mohd Ismail

- 012-2756167 /
- 03-31698888 ext. 4291

Manager on duty :

Mr. Mohd Reza Muliawan Bin Mohd Noor

- 019-3043443
- 03-31698888 ext. 4475

Pilot Office

- Channel 12
- 03-31698910

Health Safety & Environment (HSE) :

Mr. Mohd Radzai Bin Mohd Salleh

- 012-2970892
- 03-31698888 ext. 22647

In case of Emergency

Contact Us

Port Control Centre (PCC)

- 03-31698832 ext:-22613
- 019-6003209
- 4999 S/D

Fire & Rescue Services

- 03-31766371 / 03-31686142

Via email

bomba@northport.com.my

Visit us on the Web:

www.northport.com.my/safetyguideline

Safety Guideline

Do's

- Wear Personal Protective Equipment (PPE).
- Wear life jacket at Life gazette area.
- Identify the nearest emergency exit point.
- Identify the nearest location of emergency shower & eye shower.
- Identify the location of the nearest fire extinguisher & life buoy.
- Comply with the conditions stated at the permitted area.

Don'ts

- Smoking, use of matches, lighter or any other source of ignition.
- Wear hob-nailed shoes.
- Perform any kind of work without prior authorization.
- Use non-intrinsically safe equipment.
- Bring photo, or video camera into the terminal without prior authorization from LBT officer/port police.
- Leave any garbage, litter .